

Solar Science Station

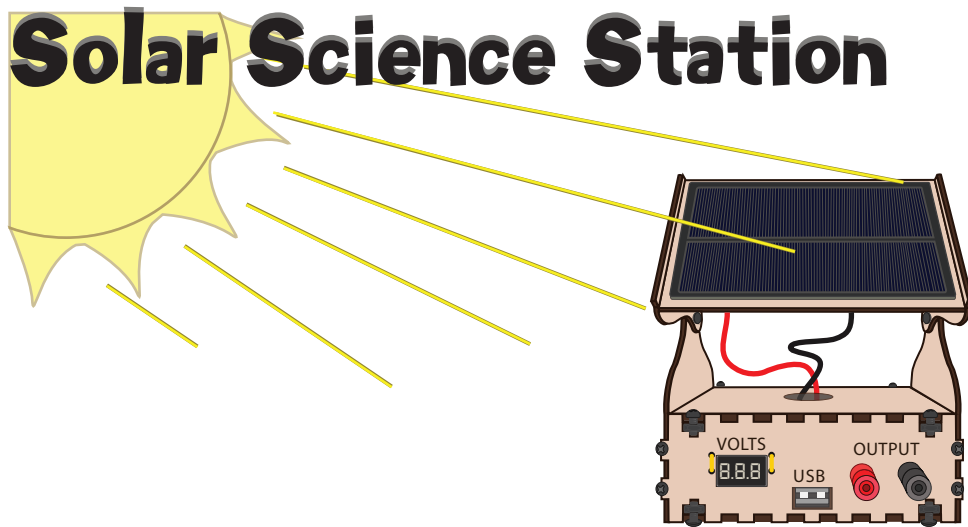

TIME:
30-60 MINUTES

YOU WILL NEED:

PARTS:



6V 200mA
Solar Cell

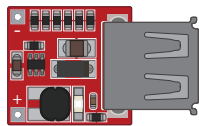

USB Charging
Circuit

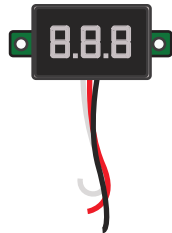

LED Voltmeter

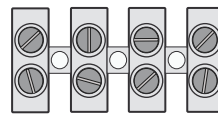

4 Port Screw
Terminal Block



24 Screws
and Nuts

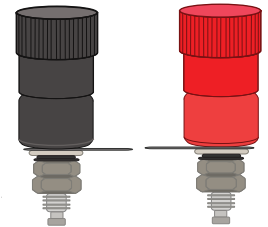

Banana Socket
(Black and Red)



Stranded
Wire



Solid Core
Wire



Double-Sided
Foam Tape



Velcro

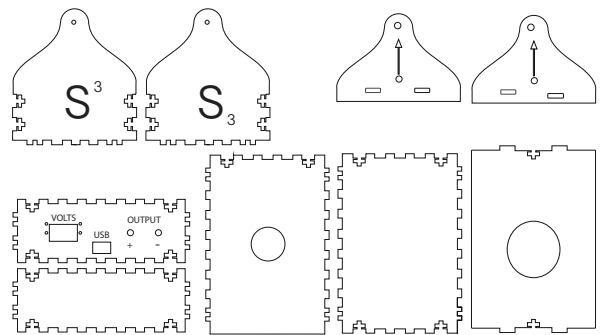

Wooden Case

TOOLS:

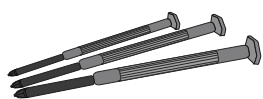

Screwdrivers



Scissors



Wire Strippers

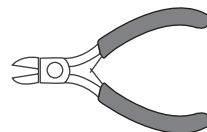

Wire Cutters

Please visit www.BrownDogGadgets.com for more great ideas & info.

1 STRIP WIRES

Strip the ends of the loose black and red wires, including the ones on the battery holder and solar panel.

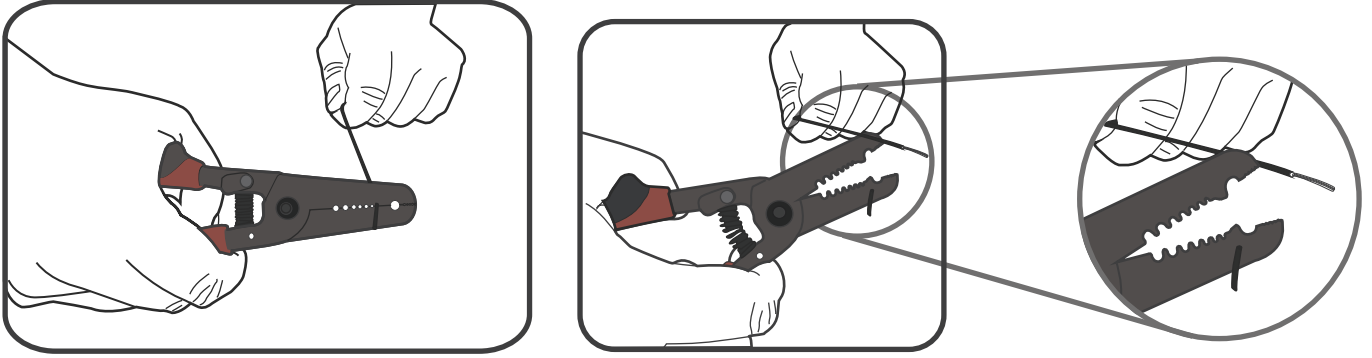

2 ATTACHING PARTS

Cut the velcro in half and attach to the solar cell and wood panel.

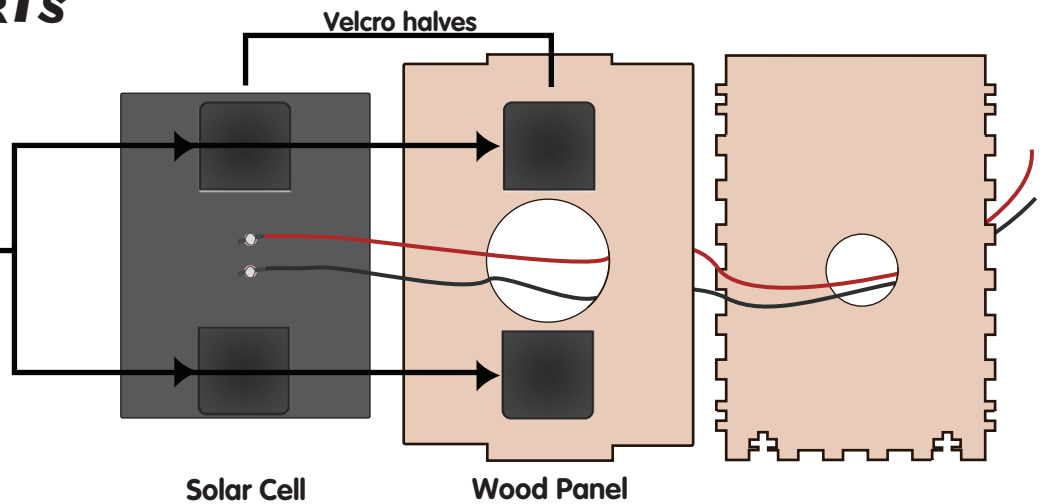

3 INSTALL HARDWARE in FACEPLATE

Use the screws on the back of the Banana Plug to secure the loose red and black wires in place.

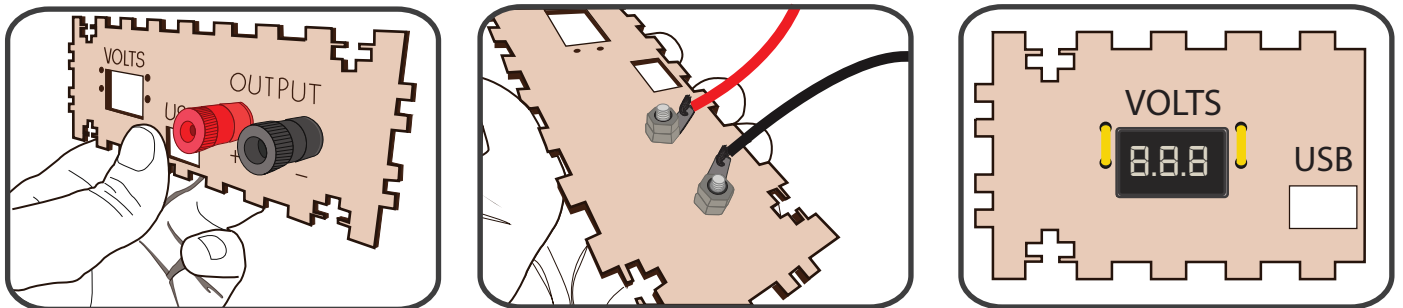

Use the piece of stranded core wire like a twist tie to hold the volt meter in place. You may need to cut it in half.

4 WIRING

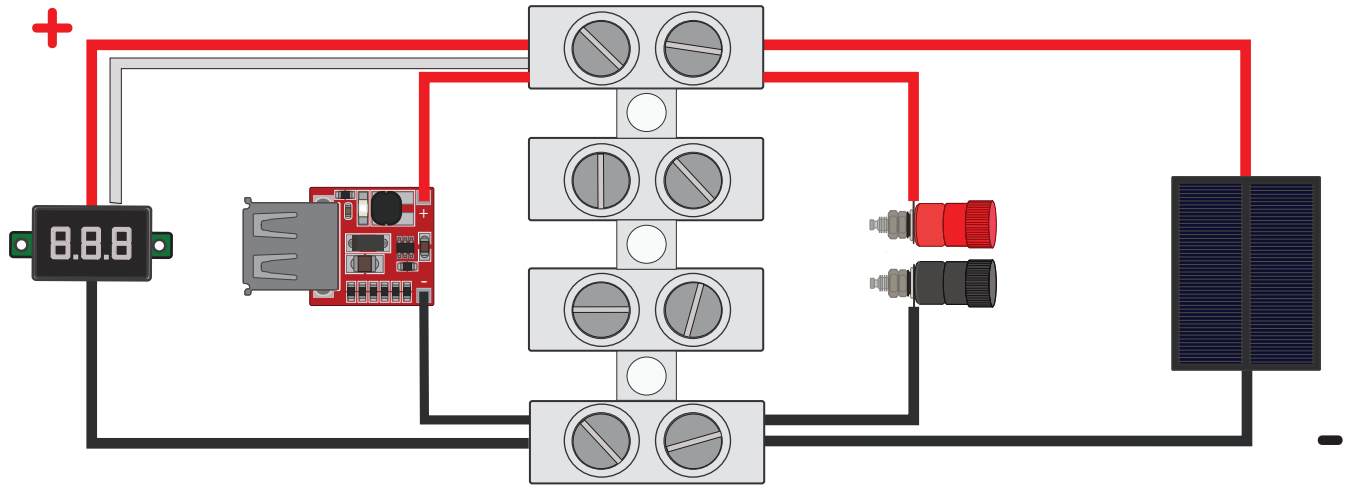

5 ASSEMBLE the BOX

Use the foam tape to secure the USB circuit to the base of the wooden box. If you're using a battery pack, but the foam tape in half and use the extra tape for the battery holder.

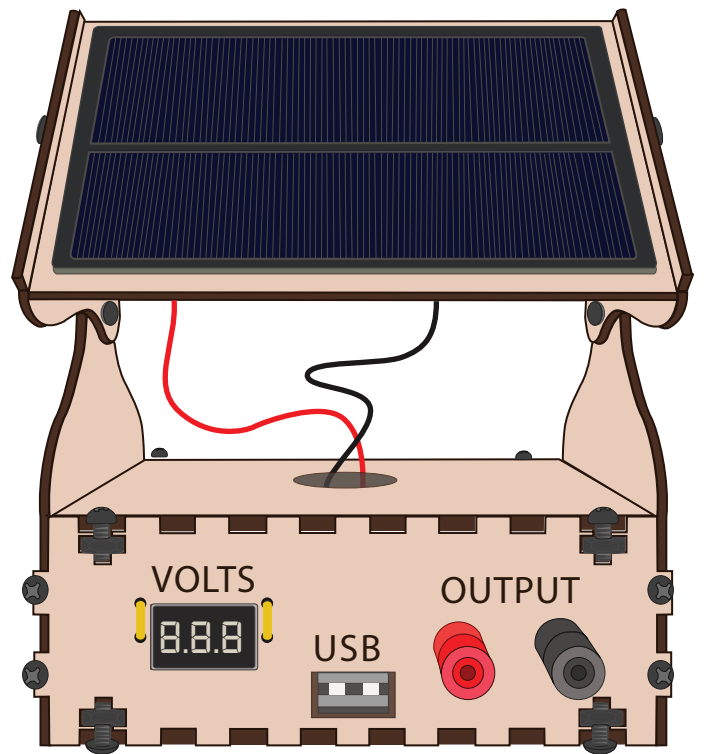
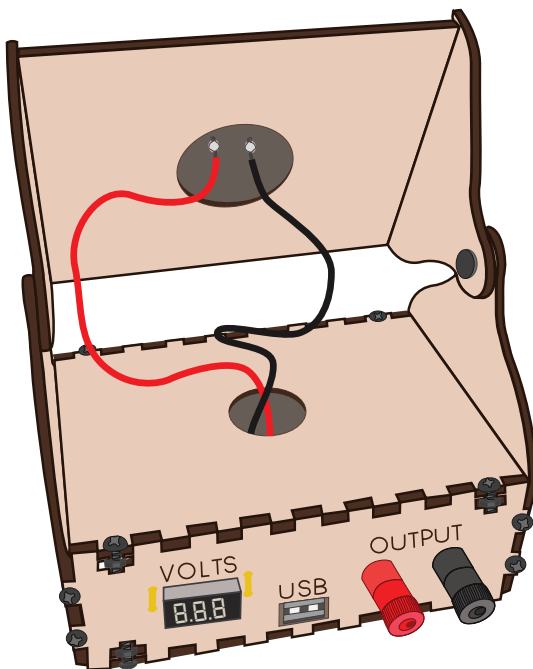
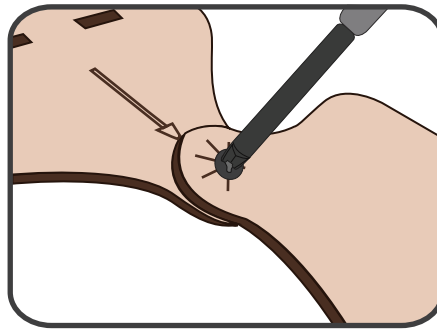
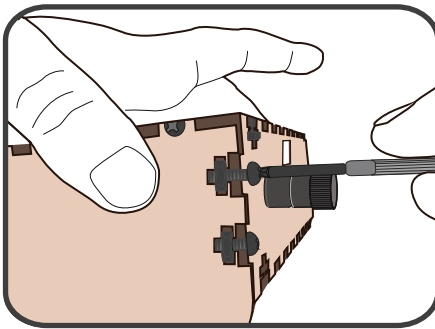

Please visit www.BrownDogGadgets.com for more great ideas & info.

7 WIRING

