







Paper cube build guide

* For better results recommended to print on heavier paper!!

- 1 Print & color your template 
- 2 Cut along the solid lines 
- 3 Fold along the dotted lines 
- 4 Cut a slit with an exacto knife 
- 5 Assemble circuit using instructions: 
- 6 Glue or tape it together 

Circuit assembly instructions:

Pull tab

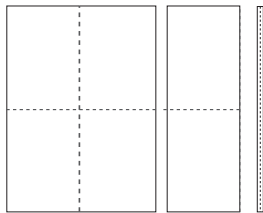

1. Place tape from the middle fold line, around the nearest open end and to the fold line on the opposite side. Make sure the dotted line is not covered by the tape.

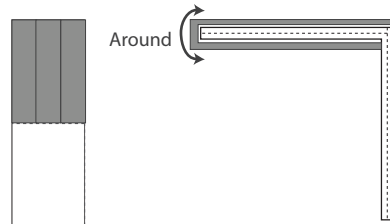

2. Fold in half the long way. Fold this new section in half along remaining dotted line.

Circuits

Robot Head

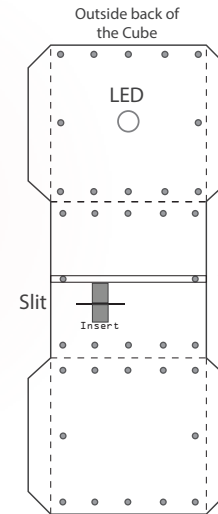
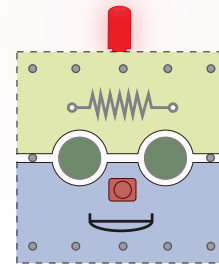

Wrap tape through the slit to the front

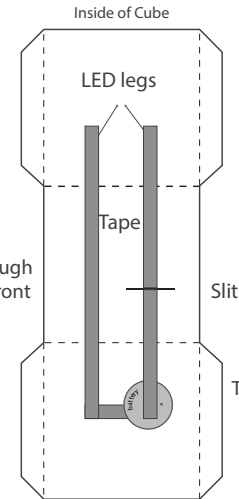

Tape on top of the battery

Robot Body

Make a tape loop to stick the battery down

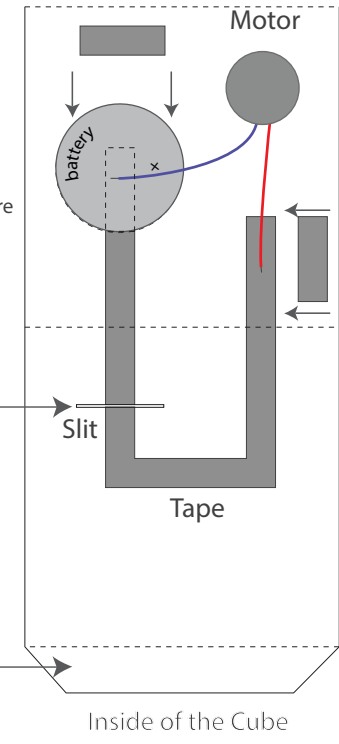
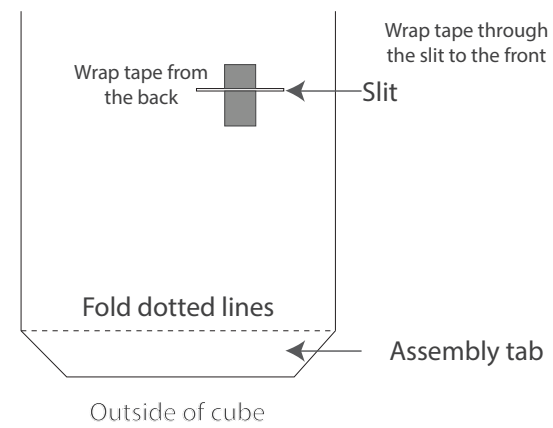
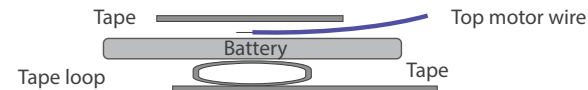

For more design templates, videos, and full instructions:
www.BrownDogGadgets.com